

# KSS Series

## Subminiature Side Actuated Tact Switch for SMT



### Features/Benefits

- **Low profile of 1.6 mm**
- **Excellent tactile feel**
- **High shear force**
- **Range of actuation forces**
- **Large flat top**
- **Redundant contacts option**
- **Date code marking**

### Typical Applications

- **Cellular phone**
- **PDA, pagers**
- **Industrial electronics**
- **Health diagnostic electronics**

**B** Tactile Switches

### Specification

FUNCTION: momentary action  
 CONTACT ARRANGEMENT: N.O.  
 TERMINALS: Gullwing & 3-Way type for SMT

### Mechanical

Type	Operating force Newtons (grams)	Operating life (operations)	Travel
KSS221G	2.0 (200) ± 25%	100,000	0,3 ± 0,15
KSS231G	2.5 (250) ± 20%	100,000	0,3 ± 0,10
KSS233W	2.5 (200) ± 25%	100,000	0,3 ± 0,15
KSS241G	4.0 (400) ± 25%	100,000	0,3 ± 0,15

### Electrical

	Silver	Gold
MAXIMUM POWER:	1 VA	0.2 VA
MAXIMUM VOLTAGE:	50 VDC	50 VDC
MAXIMUM CURRENT:	50 mA	10 mA
MINIMUM CURRENT:	1 mA	1 mA

DIELECTRIC STRENGTH: ≥ 250 VDC  
 CONTACT RESISTANCE: ≤ 100 mΩ  
 INSULATION RESISTANCE (100 VDC): ≥ 10<sup>9</sup> Ω  
 BOUNCE TIME: ≤ 3 ms

### Environmental

	Silver	Gold
OPERATING TEMPERATURE:	-40°C to 85°C	-40°C to 125°C
STORAGE TEMPERATURE:	-55°C to 85°C	-55°C to 125°C

### Process

SOLDERING: Infrared reflow in accordance with CECC00802

### Packaging

Switches are delivered in tape and reels of 3,000 pieces. The reel diameter is 330mm (12.992 x .15). The tape dimensions conform to the EIA-RS-481 and CE-2863 norms.

**NOTE:** Part numbers listed above do not represent all possible configurations. For information on specific and custom switches, consult Customer Service Center.

### How To Order

Our easy build-a-switch concept allows you to mix and match options to create the switch you need. To order, select desired option from each category and place it in the appropriate box.

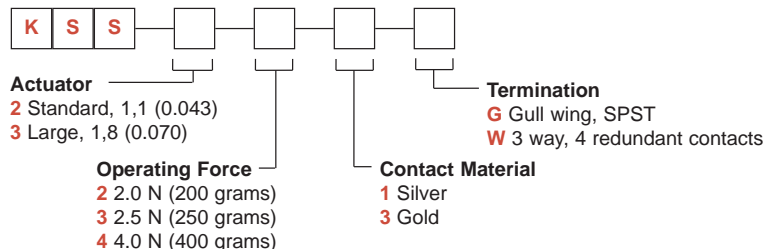

# KSS Series Subminiature Side Actuated Tact Switch for SMT

SERIES

KSS



KSS221G

Each piece is date code printed:  
1st Line: 9308 = Year 1999, 308 day in the year  
2nd Line: 221XA = Manufacturing code.

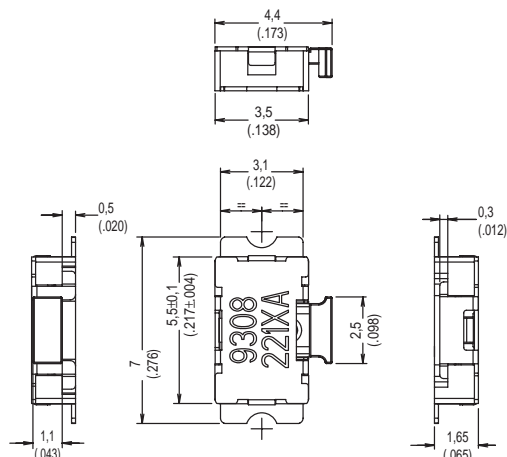

ACTUATOR

2 STANDARD, 1.1 (0.043)

3 LARGE, 1.8 (0.070)

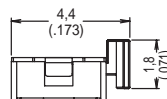
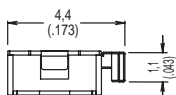

OPERATING FORCE

OPTION CODE	OPERATING FORCE
2	2.0 N (200 grams)
3	2.5 N (250 grams)
4	4.0 N (400 grams)

CONTACT MATERIAL

OPTION CODE	MATERIAL
1	SILVER
3	GOLD

TERMINATION

G GULLWING

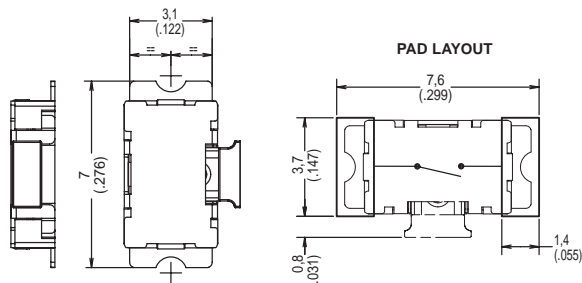

W 3 WAY, 4 REDUNDANT CONTACTS

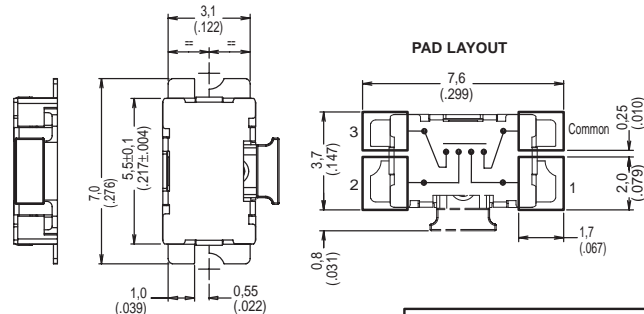

# KSS Series Subminiature Side Actuated Tact Switch for SMT

## TAPE & REEL

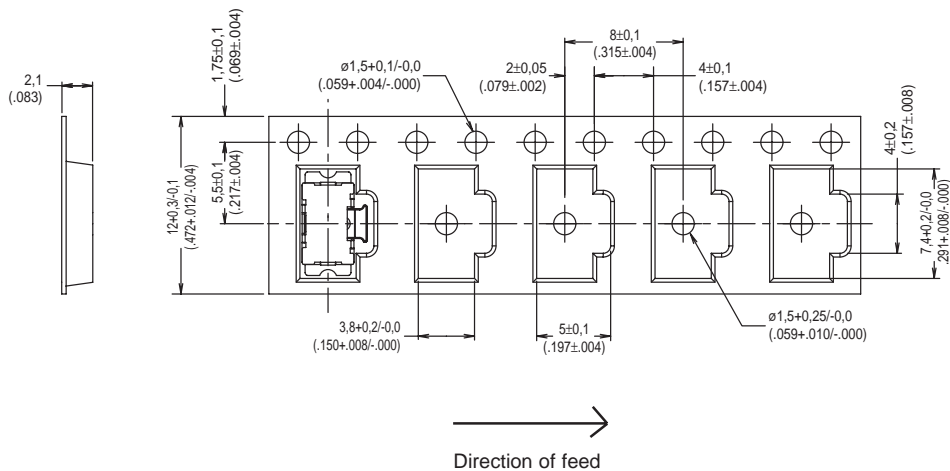

B

Tactile Switches