

RoHS Compliant Product

A suffix of "-C" specifies halogen & lead-free

## FEATURES

High voltage PNP Transistor

TO-92

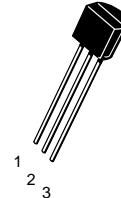

- 1. EMITTER
- 2. BASS
- 3. COLLECTOR

## MAXIMUM RATINGS (T<sub>A</sub>=25°C unless otherwise noted)

Symbol	Parameter	Value	Units
V <sub>CB0</sub>	Collector-Base Voltage	-300	V
V <sub>CEO</sub>	Collector-Emitter Voltage	-300	V
V <sub>EBO</sub>	Emitter-Base Voltage	-5	V
I <sub>C</sub>	Collector Current -Continuous	-500	mA
P <sub>C</sub>	Collector Power Dissipation	625	mW
T <sub>j</sub>	Junction Temperature	150	°C
T <sub>stg</sub>	Storage Temperature	-55-150	°C
R <sub>eJA</sub>	Thermal Resistance, junction to Ambient	200	°C/mW
R <sub>eJC</sub>	Thermal Resistance, unction to Case	83.3	°C/mW

## ELECTRICAL CHARACTERISTICS (T<sub>amb</sub>=25°C unless otherwise specified)

Parameter	Symbol	Test conditions	MIN	TYP	MAX	UNIT
Collector-base breakdown voltage	V <sub>(BR)CBO</sub>	I <sub>C</sub> =-100µA, I <sub>E</sub> =0	-300			V
Collector-emitter breakdown voltage	V <sub>(BR)CEO</sub>	I <sub>C</sub> =-1mA, I <sub>B</sub> =0	-300			V
Emitter-base breakdown voltage	V <sub>(BR)EBO</sub>	I <sub>E</sub> =-100µA, I <sub>C</sub> =0	-5			V
Collector cut-off current	I <sub>CBO</sub>	V <sub>CB</sub> = -200 V I <sub>E</sub> =0			-0.25	µA
Emitter cut-off current	I <sub>EBO</sub>	V <sub>EB</sub> = -5 V, I <sub>C</sub> =0			-0.1	µA
DC current gain	h <sub>FE(1)</sub>	V <sub>CE</sub> = -10 V, I <sub>C</sub> =- 1 mA	60			
	h <sub>FE(2)</sub>	V <sub>CE</sub> = -10V, I <sub>C</sub> = -10 mA	80		250	
	h <sub>FE(3)</sub>	V <sub>CE</sub> = -10 V, I <sub>C</sub> = -80 mA	60			
Collector-emitter saturation voltage	V <sub>CE(sat)</sub>	I <sub>C</sub> = -20 mA, I <sub>B</sub> = -2 mA			-0.2	V
Base-emitter saturation voltage	V <sub>BE(sat)</sub>	I <sub>C</sub> = -20 mA, I <sub>B</sub> = -2 mA			-0.9	V
Transition frequency	f <sub>T</sub>	V <sub>CE</sub> = -20 V, I <sub>C</sub> = -10 mA f = 30MHz	50			MHz

## CLASSIFICATION OF h<sub>FE(2)</sub>

Rank	A	B <sub>1</sub>	B <sub>2</sub>	C
Range	80-100	100-150	150-200	200-250

**Typical Characteristics**

**A92**

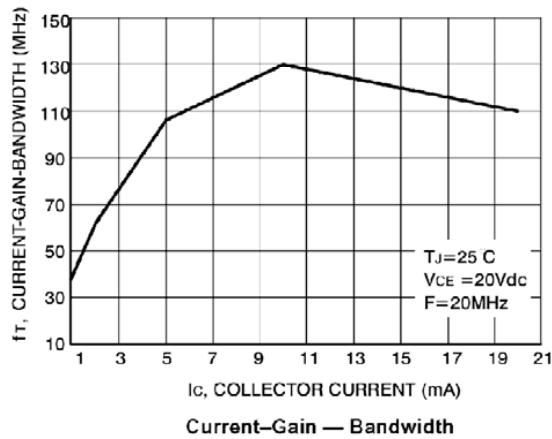
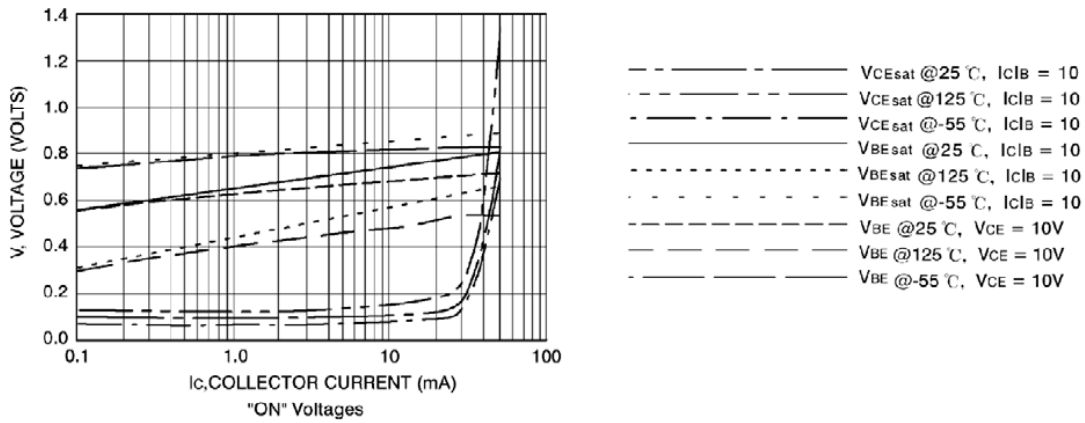
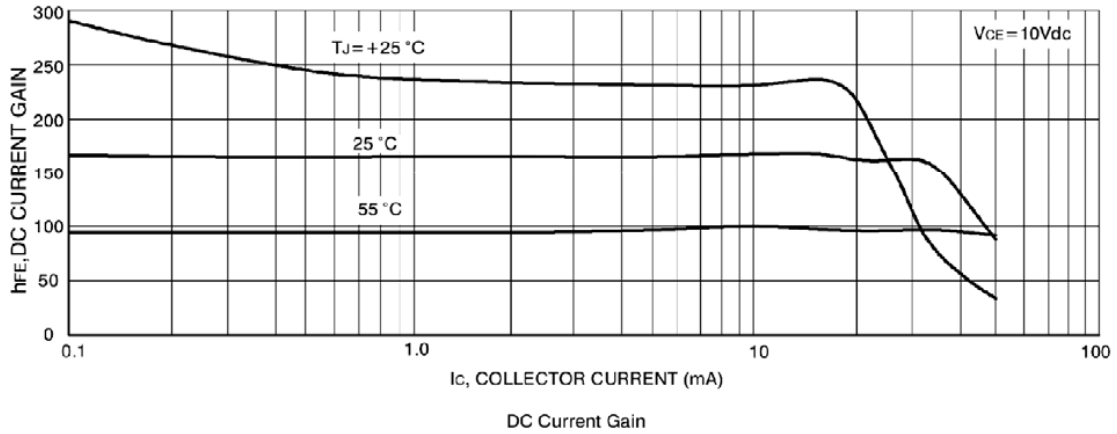

● TO-92 PACKAGE OUTLINE DIMENSIONS

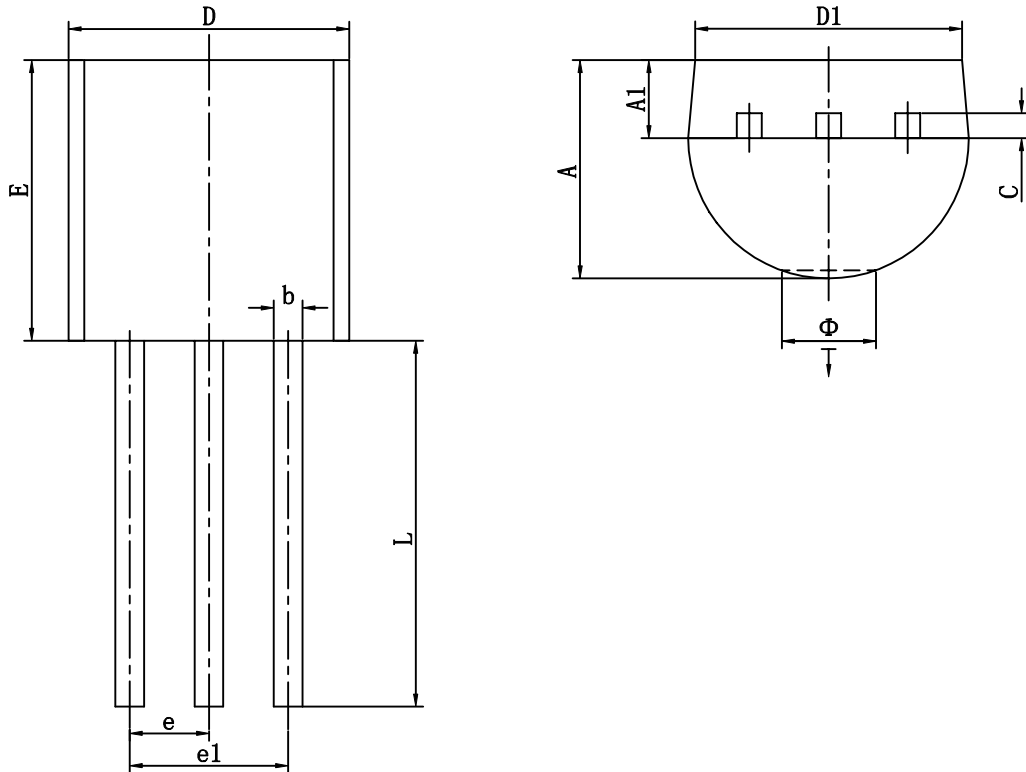

Symbol	Dimensions In Millimeters		Dimensions In Inches	
	Min	Max	Min	Max
A	3.300	3.700	0.130	0.146
A1	1.100	1.400	0.043	0.055
b	0.380	0.550	0.015	0.022
c	0.360	0.510	0.014	0.020
D	4.400	4.700	0.173	0.185
D1	3.430		0.135	
E	4.300	4.700	0.169	0.185
e	1.270TYP		0.050TYP	
e1	2.440	2.640	0.096	0.104
L	14.100	14.500	0.555	0.571
Ø		1.600		0.063
↓	0.000	0.380	0.000	0.015