

New Jersey Semi-Conductor Products, Inc.

20 STERN AVE.
 SPRINGFIELD, NEW JERSEY 07081
 U.S.A.

TELEPHONE: (201) 376-292
 (212) 227-600
 FAX: (201) 376-896

PARAMETERS

1N478
 GERMANIUM DIODE

Description: Germanium Diode

Manufacturer.....	
Mil/High-Rel? (Y/N).....	
I(out) (If AVG) Max.....	50m
VRRM.....	90
1-Cycle Surge Current (A).....	
Vf Max.....	1.0
@If (test).....	5.0m
Ir @25xC.....	155u
@Volts (test) (V).....	75
Ir @ Diff. Temp (A).....	
@Temp (test) (xC).....	
Oper. Temp (xC) Max.....	75
Pkg Style.....	D0-7
Surface Mounted (Y/N).....	N

2 It(rms)

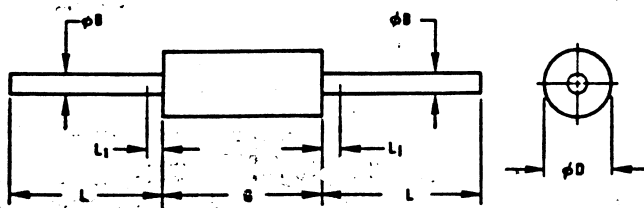

MILLIMETER DIMENSIONS ARE DERIVED FROM ORIGINAL INCH DIMENSIONS

SYMBOL	INCHES		MILLIMETERS		NOTES
	MIN.	MAX.	MIN.	MAX.	
BB	.018	.022	0.458	0.558	-
DD	.085	.107	2.16	2.71	1
G	.230	.300	5.85	7.62	1
L	1.000	-	25.40	-	-
L ₁	-	.050	-	1.27	2

NOTES:

1. PACKAGE CONTOUR OPTIONAL WITHIN CYLINDER OF DIAMETER ϕD AND LENGTH G . SLUGS, IF ANY, SHALL BE INCLUDED WITHIN THIS CYLINDER BUT SHALL NOT BE SUBJECT TO THE MINIMUM LIMIT OF ϕD .
2. LEAD DIAMETER NOT CONTROLLED IN THIS ZONE TO ALLOW FOR FLASH, LEAD FINISH BUILD-UP, AND MINOR IRREGULARITIES OTHER THAN SLUGS.



Quality Semi-Conductors